

**SEGMENTED HALF DOME SKYLIGHTS &
STRECHFORMED DOME SKYLIGHTS
2250 SERIES
UP TO 7' RAFTER SPAN 2' OC.**

Sky-Tech Glazing Systems, LLC.

Mailing Address: 160 W. Foothill PKWY Suit 105 #212, Corona , CA 92882
Physical Address: 402 E. Princeland Court, Suite 5, Corona, CA 92879

800-440-9999 fax : 909-606-1441

E-mail: info@sky-techglazing.com
Visit Us At www.sky-techglazing.com

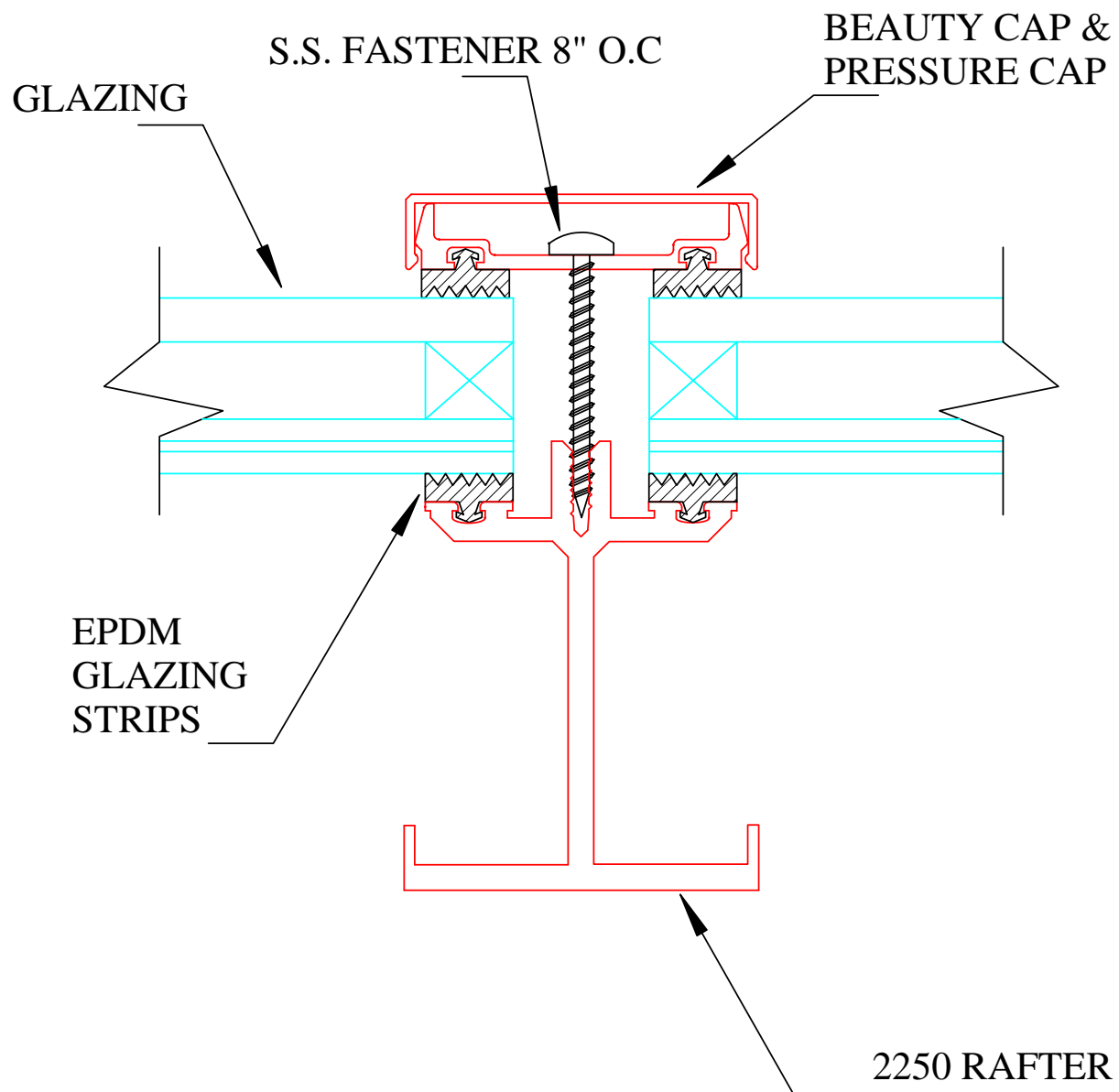

D

2250 Rafter Detail

1" = 1"

Sky-Tech Glazing Systems, LLC.

Mailing Address: 160 W. Foothill PKWY Suit 105 #212, Corona, CA 92882
Physical Address: 402 E. Princeland Court, Suite 5, Corona, CA 92879

800-440-9999 fax : 909-606-1441

E-mail: info@sky-techglazing.com
Visit Us At www.sky-techglazing.com

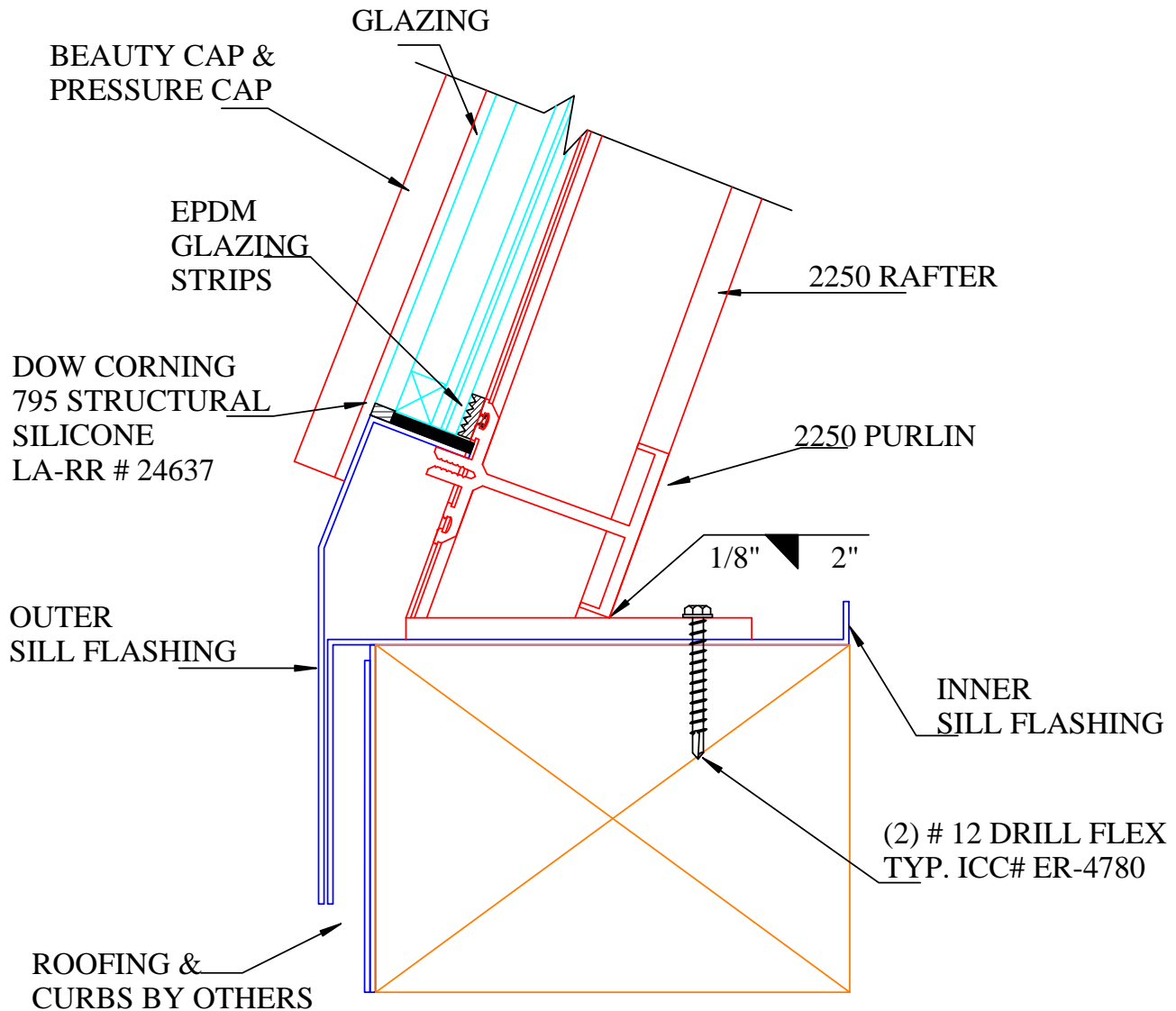

D5

2250 Segmented Sill Detail

1/2" = 1"

Sky-Tech Glazing Systems, LLC.

Mailing Address: 160 W. Foothill PKWY Suit 105 #212, Corona, CA 92882
Physical Address: 402 E. Princeland Court, Suite 5, Corona, CA 92879

800-440-9999 fax : 909-606-1441

E-mail: info@sky-techglazing.com
Visit Us At www.sky-techglazing.com

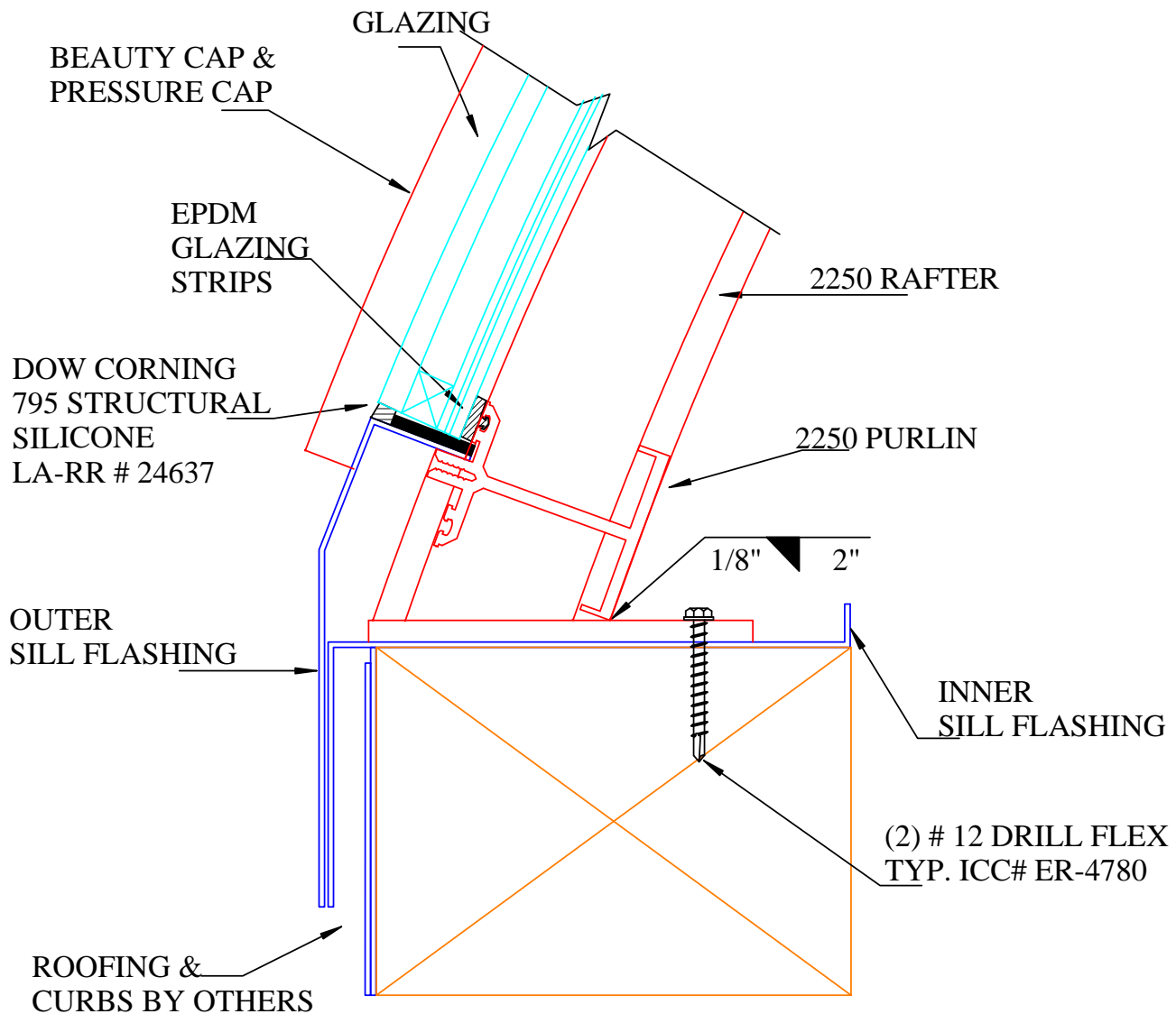

D5R

2250 Stretched Formed Sill Detail

1/2" = 1"

Sky-Tech Glazing Systems, LLC.

Mailing Address: 160 W. Foothill PKWY Suit 105 #212, Corona, CA 92882
Physical Address: 402 E. Princeland Court, Suite 5, Corona, CA 92879

800-440-9999 fax : 909-606-1441

E-mail: info@sky-techglazing.com
Visit Us At www.sky-techglazing.com

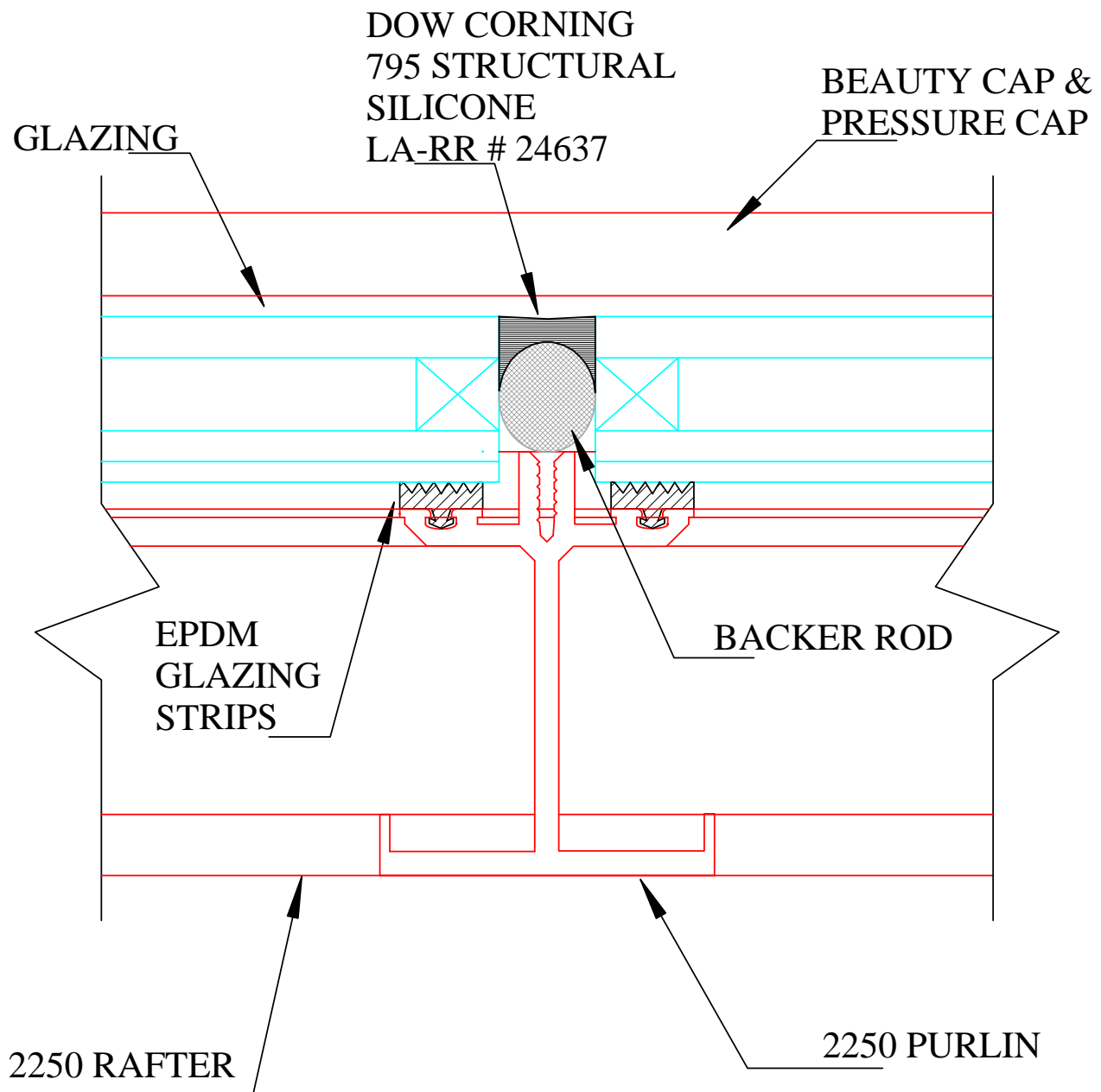

E

2250 Purlin Detail

1" = 1"

Sky-Tech Glazing Systems, LLC.

Mailing Address: 160 W. Foothill PKWY Suit 105 #212, Corona, CA 92882
Physical Address: 402 E. Princeland Court, Suite 5, Corona, CA 92879

800-440-9999 fax : 909-606-1441

E-mail: info@sky-techglazing.com
Visit Us At www.sky-techglazing.com

Cut View

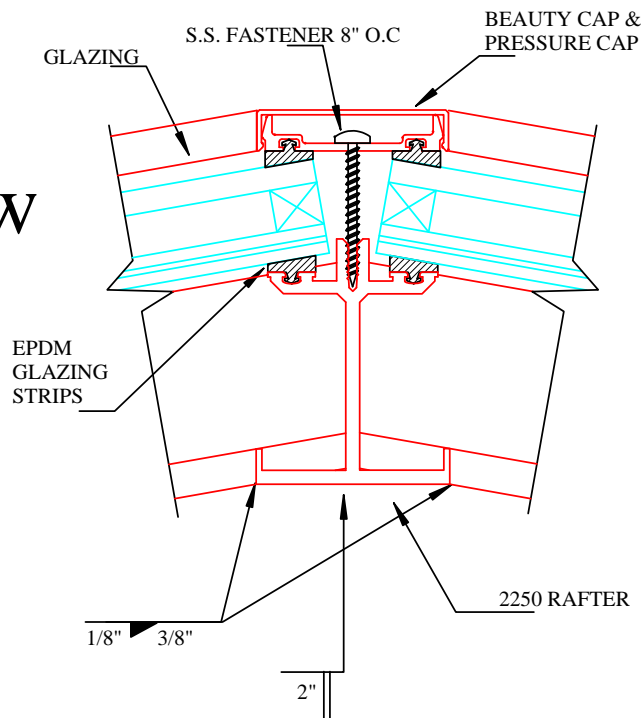

Bottom View

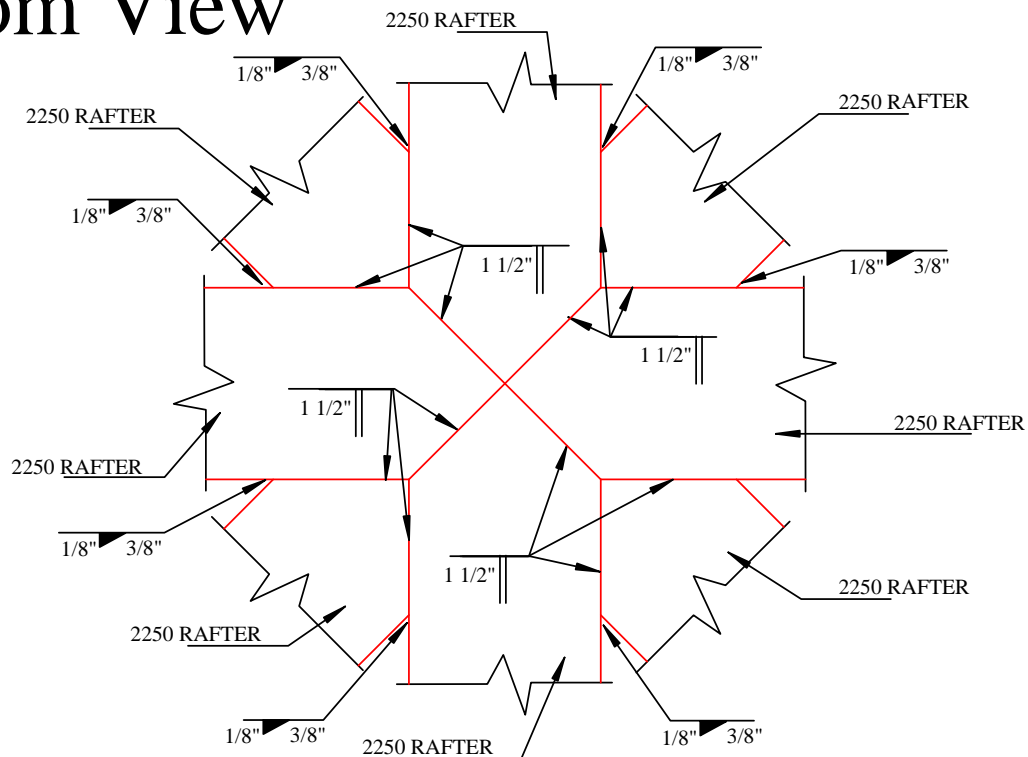

Q1

2250 Segmented Apex Detail

1/2" = 1"

Sky-Tech Glazing Systems, LLC.

Mailing Address: 160 W. Foothill PKWY Suit 105 #212, Corona, CA 92882
Physical Address: 402 E. Princeland Court, Suite 5, Corona, CA 92879

800-440-9999 fax : 909-606-1441

E-mail: info@sky-techglazing.com
Visit Us At www.sky-techglazing.com

Cut View

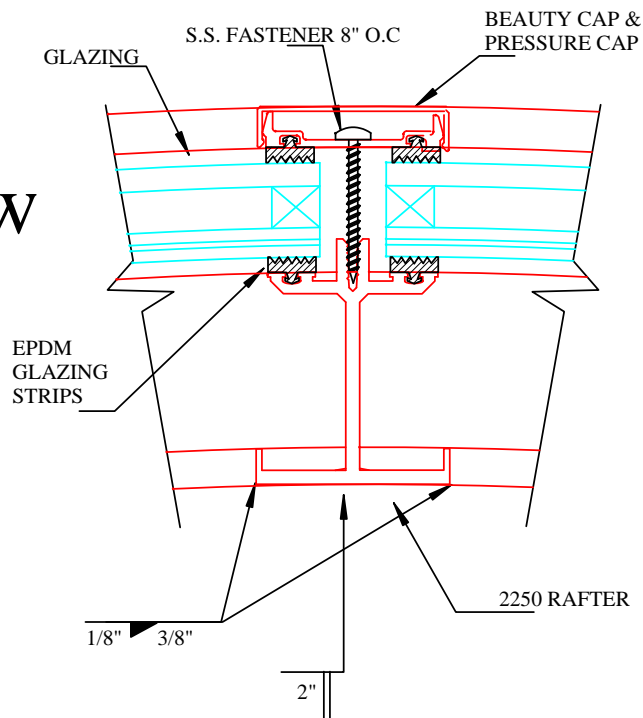

Bottom View

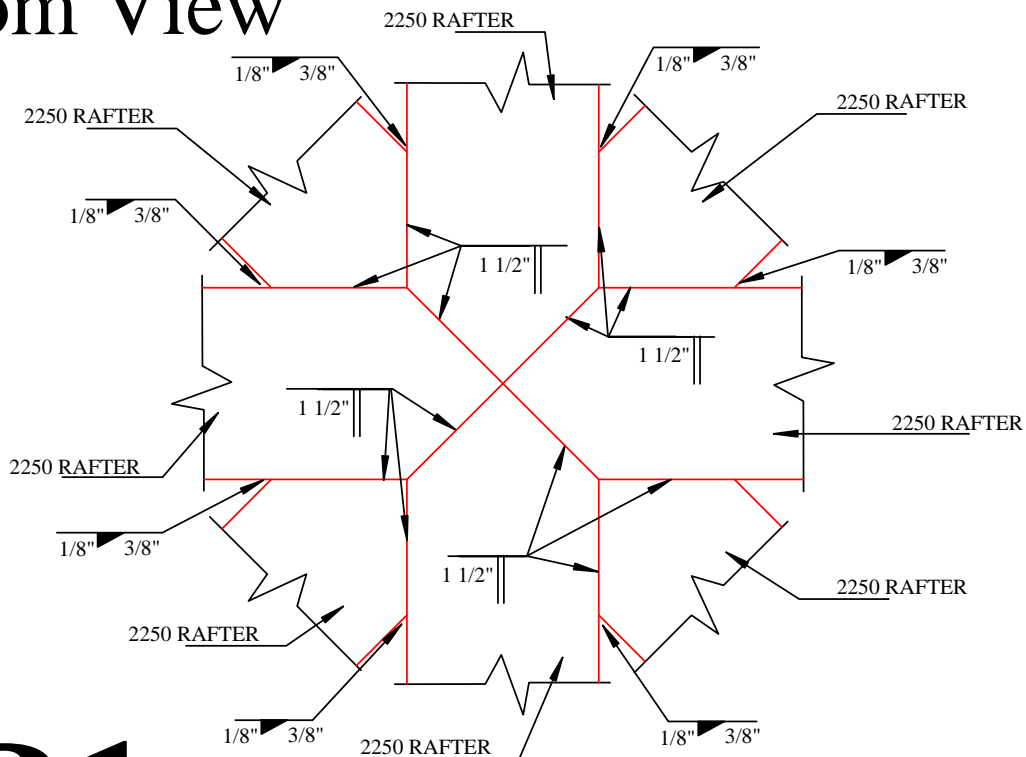

QR1

2250 Stretched Formed Apex Detail

1/2" = 1"

Sky-Tech Glazing Systems, LLC.

Mailing Address: 160 W. Foothill PKWY Suit 105 #212, Corona, CA 92882
Physical Address: 402 E. Princeland Court, Suite 5, Corona, CA 92879

800-440-9999 fax : 909-606-1441

E-mail: info@sky-techglazing.com
Visit Us At www.sky-techglazing.com